

Commercial thoroughways are important multi-modal corridors which serve high demand by automobiles, trucks, transit vehicles, and a high pedestrian volume. Providing for all users without compromising safety or functionality for others is critical on these streets.

Existing Challenges Include:

- High volume and velocity through traffic, including trucks, and loading needs of businesses
- Need for improved pedestrian safety and buffering

Basic Improvements Include:

- More consistent street trees in grates
- Sidewalk buffer planters
- Pedestrian-scale lighting
- Corner curb extensions
- High visibility crosswalks with 2 curb ramps at each corner
- A wide variety of furnishings for pedestrians
- Combined parking meters and other measures to reduce streetscape clutter

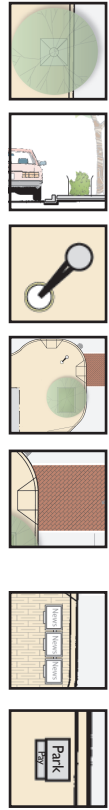

Existing

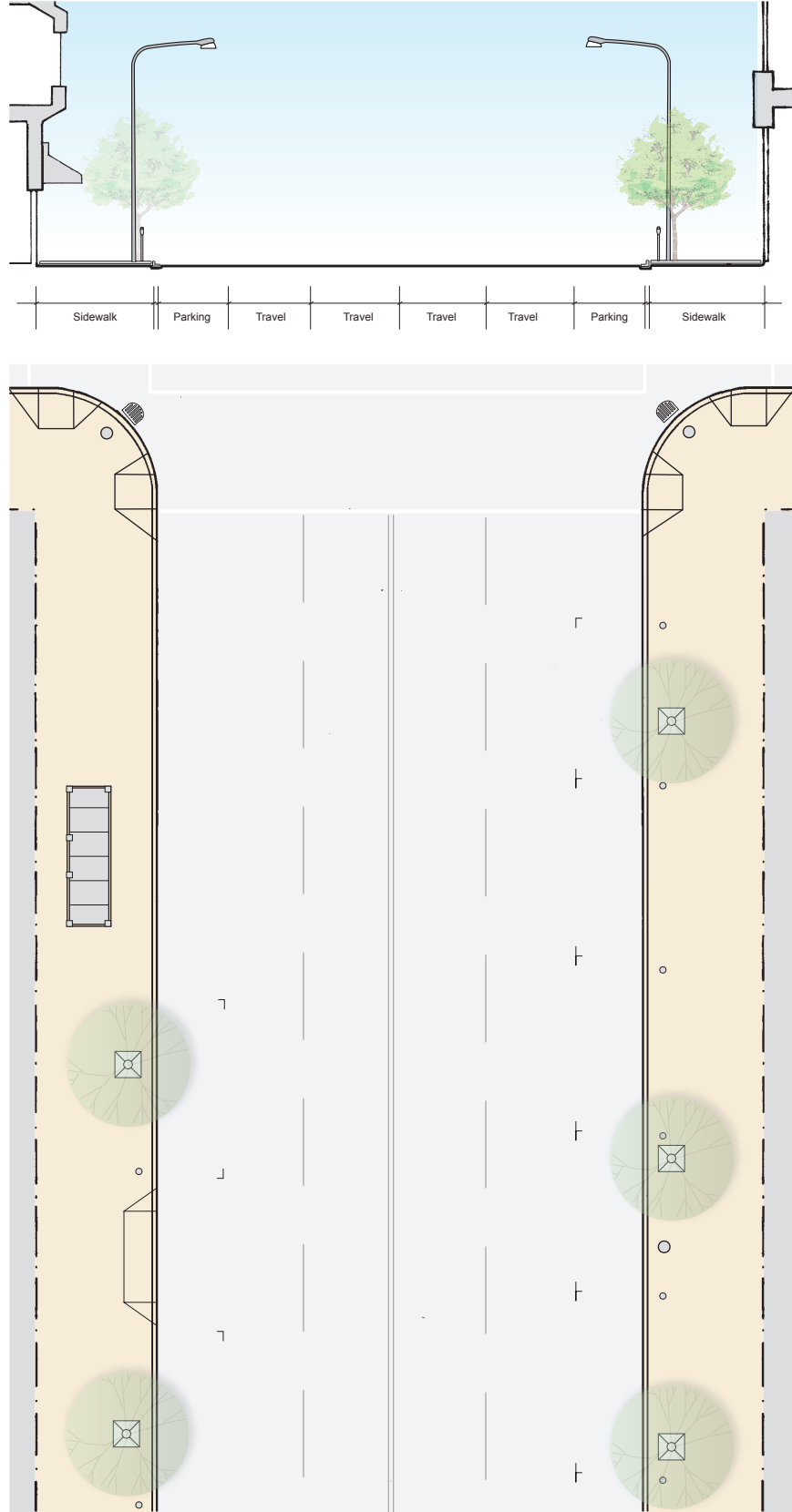

Basic Improvements

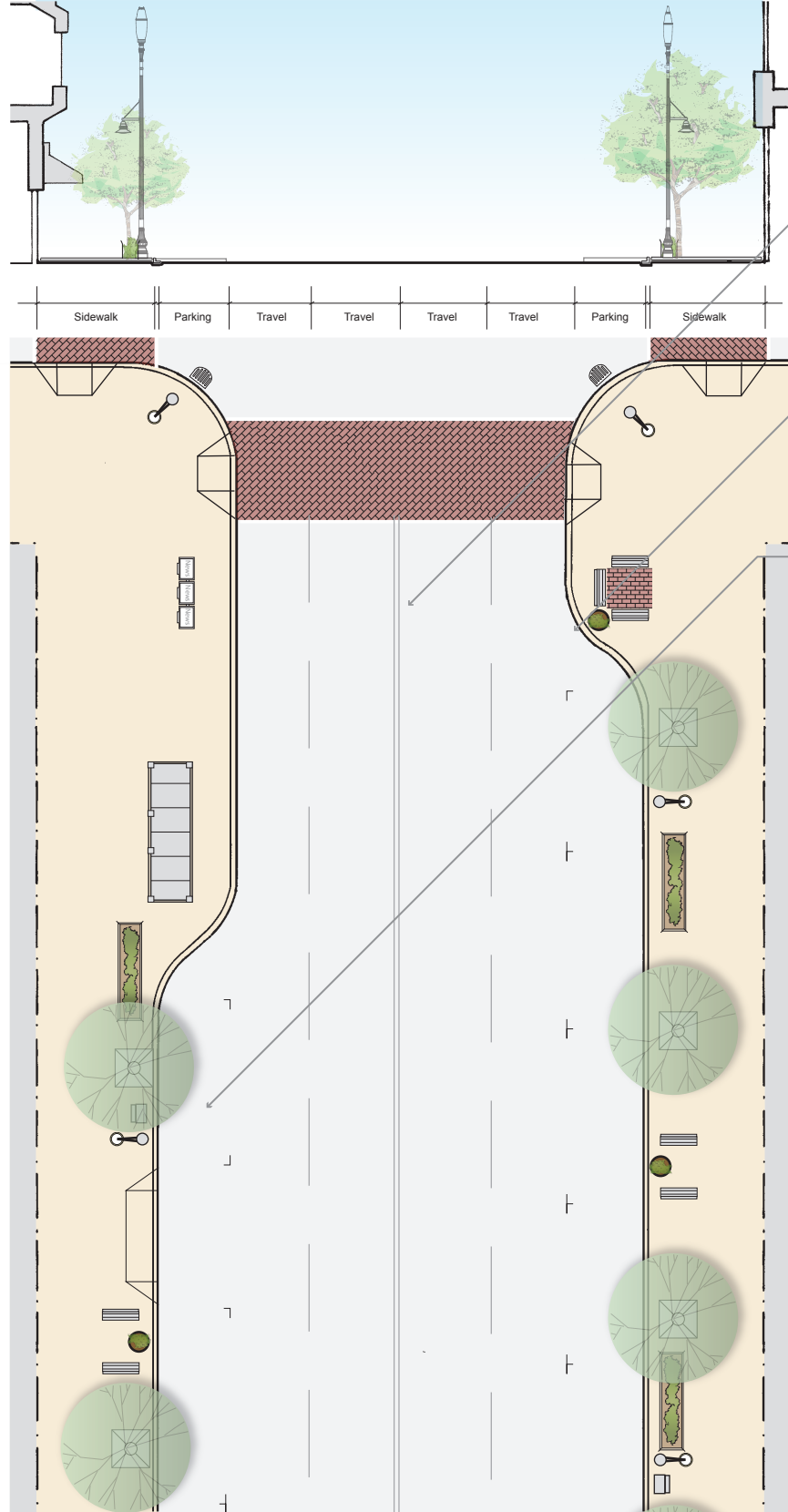

Kit of Parts to Consider

Center Median:

- Visually narrows the street to calm traffic and adds pedestrian refuge in crosswalk
- Can be landscaped with planters and/or trees
- Installation can be costly

Extended Bulbout/Corner Plaza:

- Adds significant public space for seating, transit stop, landscaping, and/or pedestrian amenities
- Can include trees, landscaping, and infiltration areas
- Installation can be costly

Flexible Parking (Esp. Bike Parking Areas):

- Parking spaces can be temporarily converted to bicycle parking where necessary to prevent sidewalk crowding, or other uses reflective of adjacent land use
- Temporary installation can be inexpensive

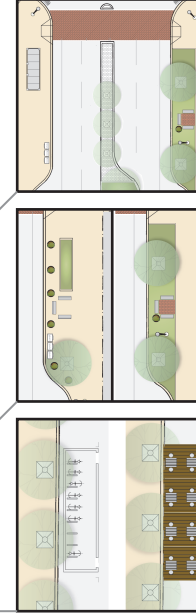

Commercial Thoroughway

