

CONCEPTUAL COST ESTIMATE & DESIGN

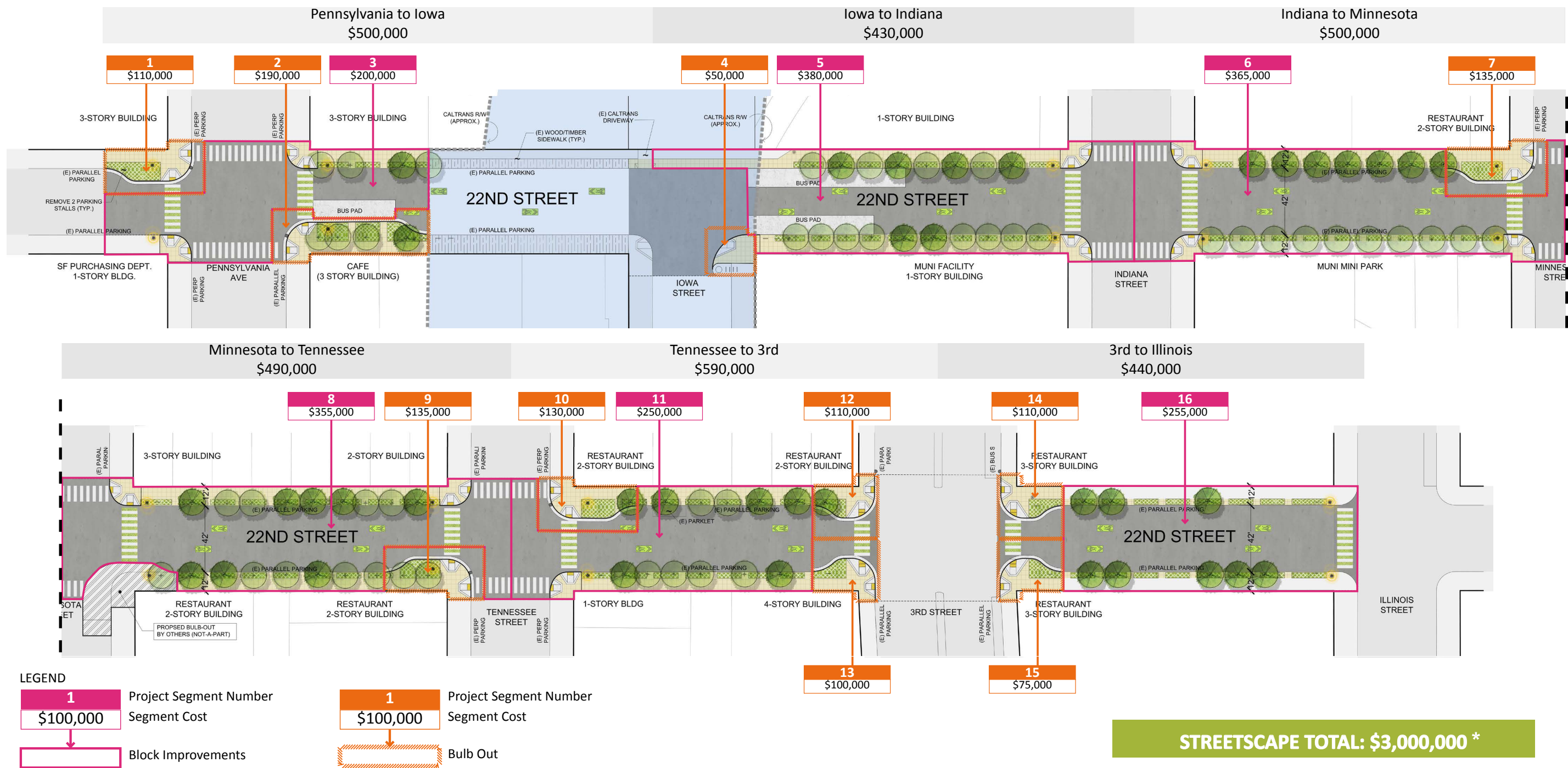

*An additional \$600,000 will come from the Public Works Paving Program budget. This includes paving from Illinois Street to Pennsylvania Avenue with the exception of the Caltrain bridge.

PROJECT SUMMARY: The 22nd Street Green Connection Streetscape project area is from Illinois Street to Pennsylvania Avenue. The project goal is to create a green, inviting connection from Illinois Street (the Blue Greenway and Bay Trail and future housing and parks) to the 22nd St Caltrain station at Iowa Street, and eventually up the hill climb to the playground and recreation center. Public realm and roadway improvements include tree and understory planting, new pedestrian lighting, replacement of sidewalk concrete where needed and installation of turf block treatments, corner sidewalk bulbouts, new painted crosswalks and bike route markings (sharrows) that will enhance this primary Dogpatch commercial corridor and strengthen the connection for people walking and cycling. The 22nd Street Green Connection Streetscape project will coordinate with Public Works paving program's repaving of 22nd Street.

For more information, please contact: Kelli Rudnick (415)-558-4489 / kelli.rudnick@sfdpw.org or visit: sf-planning.org/CentralWaterfrontPRP

FEATURES

- 6 Blocks of Repaving (\$600,000 from Paving Program)
- 19,400 SF New Sidewalks w/ Integral Color
- 9 Bulb-outs
- 42 New Street Trees
- 3 Year Maintenance for New Trees
- 7,150 SF Permeable Paving
- 7,150 SF Low-maintenance, Drought Tolerant Planting
- 7,150 SF Irrigation
- 1,855 SF Special Treatment at Crosswalks @ 6 Intersections
- 18 New Pedestrian Light Fixtures (& Conduit) @ Intersections
- 24 Painted Sharrows
- 21 Bike Posts
- 4 Trash Receptacles (at Bus Stops)

STREETSCAPE GREENING & MATERIALS PALETTE



TURF BLOCK / "GREEN FUZZ"



BICYCLE SHARROWS



SIDEWALK PLANTERS



PLANTED BULB-OUTS

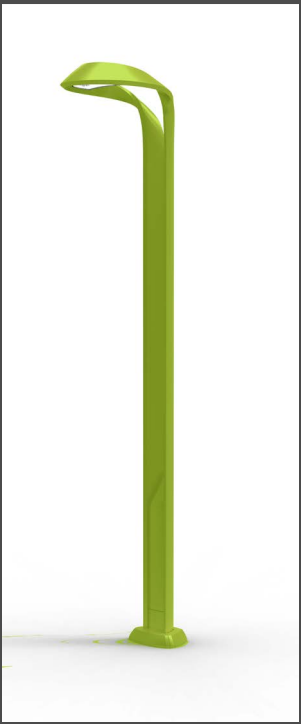

PEDESTRIAN LIGHTING

CONCEPTUAL COST ESTIMATE SUMMARY

SEGMENT	COST
1	\$110,000
2	\$190,000
3	\$200,000
4	\$50,000
5	\$380,000
6	\$365,000
7	\$135,000
8	\$355,000
9	\$135,000
10	\$130,000
11	\$250,000
12	\$110,000
13	\$100,000
14	\$110,000
15	\$75,000
16	\$255,000
Survey	\$50,000
TOTAL	\$3,000,000
PAVING	*\$600,000
PROJECT TOTAL	**\$3,600,000

*600K for paving will come from the Public Works Paving Program budget. Illinois Street to Pennsylvania Ave (with the exception of the Caltrain bridge)

**PROJECT TOTAL INCLUDES

SOFT COSTS	
Project Management	3%
Design (SF Public Works)	12%
Construction Support	5%
Construction Management	10%

SCHEDULE

Summer through Fall 2015
DOGPATCH & POTRERO COMMUNITY OUTREACH

October 19 final presentation and additional funding request
EASTERN NEIGHBORHOODS COMMUNITY ADVISORY COMMITTEE MEETINGS

November/December 2015
22ND ST COMMUNITY WORKSHOP

January 2016 through October 2016
22ND ST CALTRAIN BRIDGE CONSTRUCTION



SPECIAL PAVING AT CROSSWALKS



BIKE RACKS